

# The benefits of a Milestone and ICT integration.

These integrations allow operators to bring ICT's unified access control, security, and building automation solution into XProtect or Milestone XProtect's powerful VMS functionality into Protege GX to achieve a single pane of glass view of buildings and sites.

By purchasing both the Milestone XProtect and Protege GX front-end integrations, you can enable a seamless bi-directional integration.

## Key features.

### Milestone XProtect front-end.

| Description                              | Part Code                           | SKU        |
|--|-------------------------------------|------------|
| Protege GX Milestone VMS Int Lic         | PRT-GX-VMS-MLSTN                    | 1140002411 |
| Protege GX Milestone VMS Annual Care Pln | PRT-GX-VMS-MLSTN-ACP Isolated Comms | 1140002621 |

When you implement the Milestone XProtect front-end integration you can:

- > Achieve a full understanding of what's happening across your buildings and sites by adding Protege GX doors into XProtect maps
- > Mitigate the risk of disparate systems with the ability to set up custom alarms based on Protege GX events in XProtect
- > Ensure the right people are requesting access to a door thanks to access request notifications synced to camera footage
- > Reduce workload for staff thanks to the ability to oversee and control Protege GX doors, areas, inputs, and outputs in XProtect

This integration falls under our Annual Care Plan – please talk to your Regional Sales representative for more details.

### Protege GX front-end.

| Description              | Part Code     | SKU        |
|--------------------------|---------------|------------|
| Protege GX 10 Camera Lic | PRT-GX-CAM-10 | 1001500003 |
| Protege GX 50 Camera Lic | PRT-GX-CAM-50 | 1001500046 |

When you implement the Protege GX front-end integration you can:

- > Easily validate users and events by embedding cameras directly into a Protege GX status page
- > Reduce time spent going through footage to find when and where an incident took place by linking cameras to doors, areas, inputs, or outputs
- > Gain immediate oversight by automatically launching a pop-up camera window when specified events occur
- > Streamline workloads by viewing Milestone XProtect HLI events directly within Protege GX, including:
  - Sensor alarms
  - Abnormal records
  - Motion detection

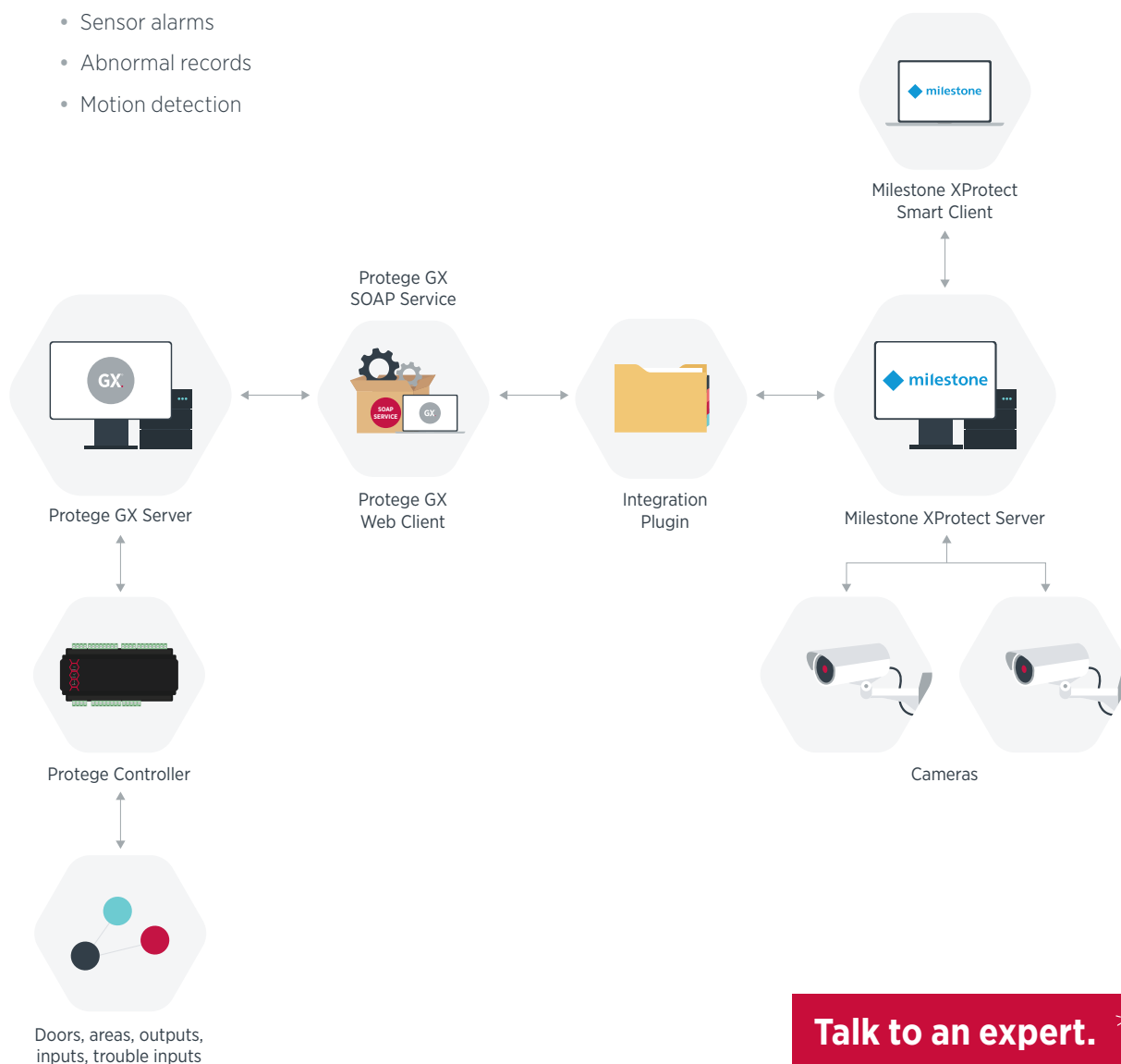

**Talk to an expert.**